

Installation instructions for pitched roof ballast system - folding triangles

Stage 1

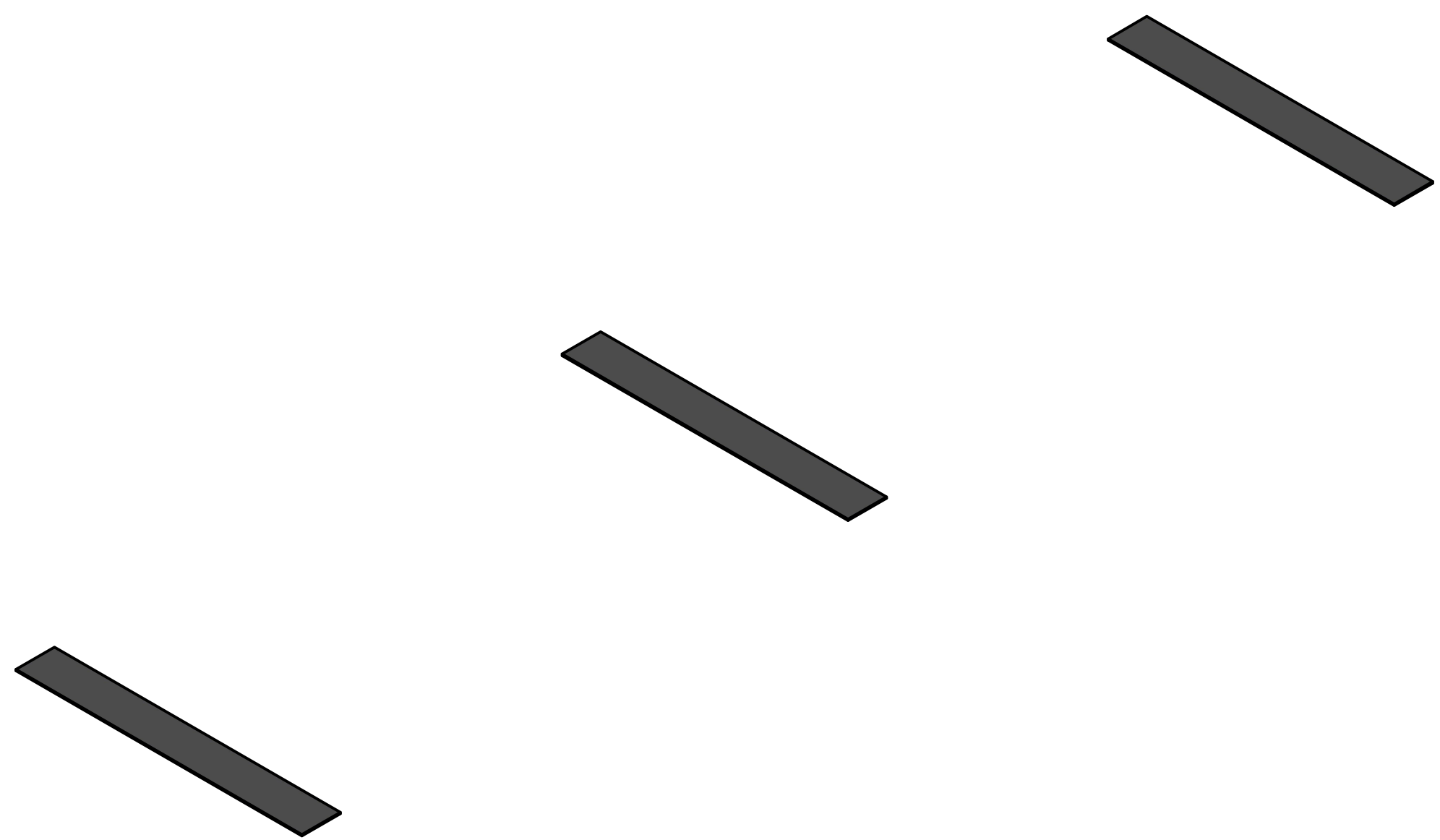

In the first step, we deploy the rubber pads. The spacing depends on the module used.

Stage 2

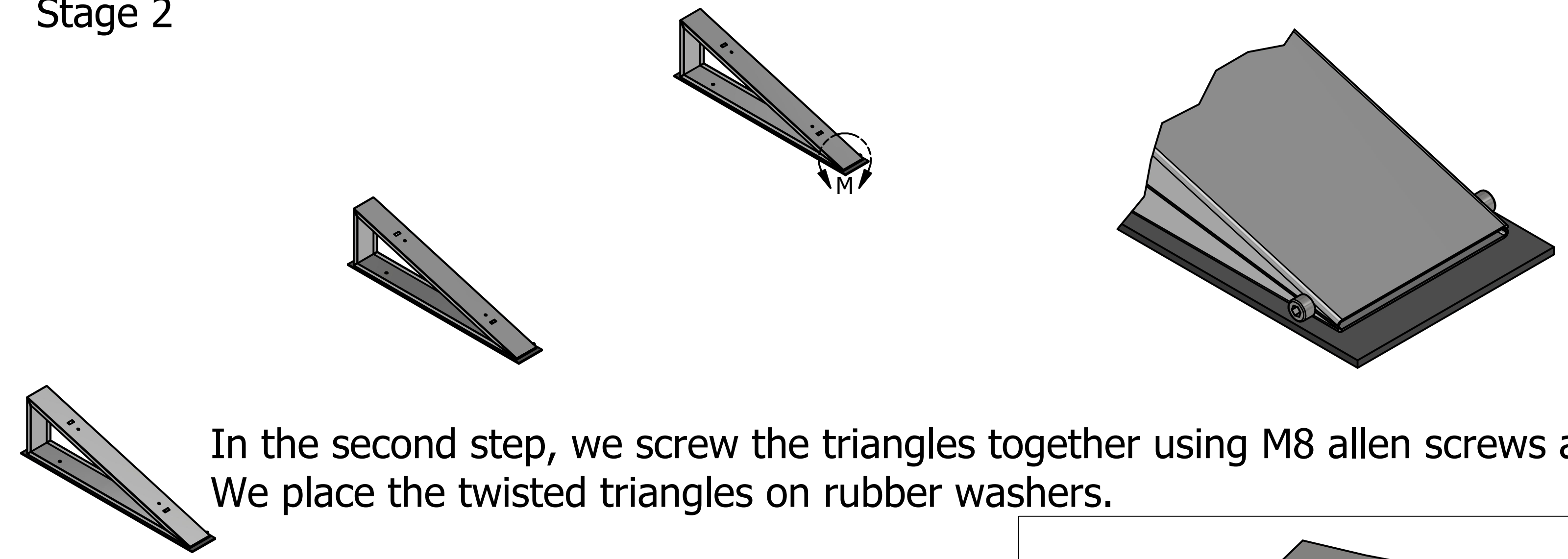

In the second step, we screw the triangles together using M8 allen screws and threaded. We place the twisted triangles on rubber washers.

Stage 3

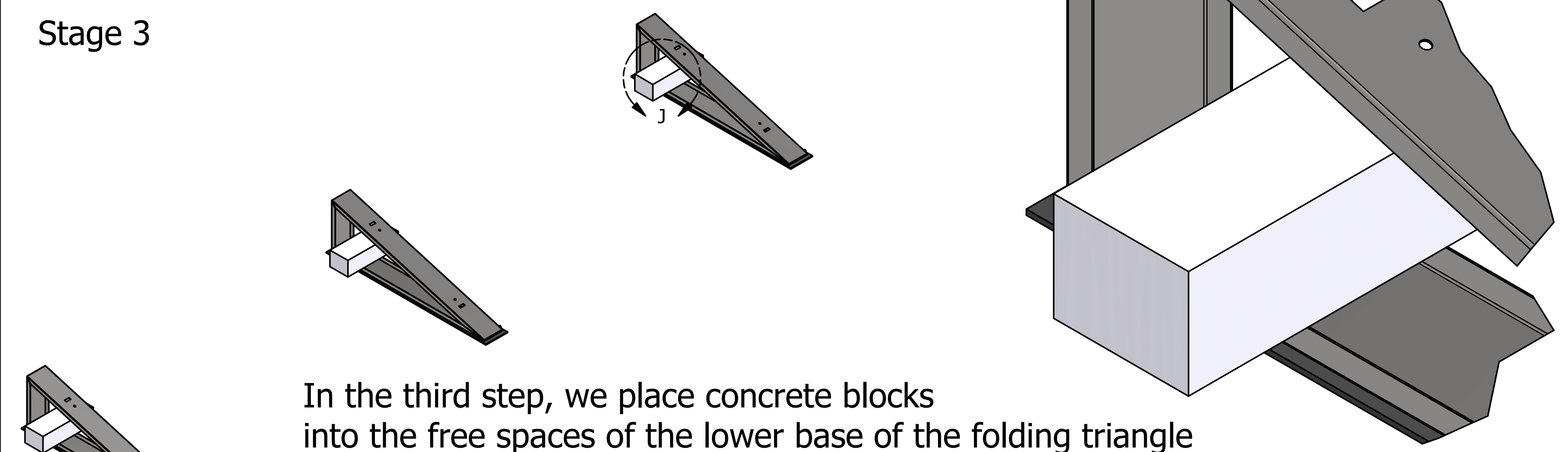

In the third step, we place concrete blocks into the free spaces of the lower base of the folding triangle

Stage 4

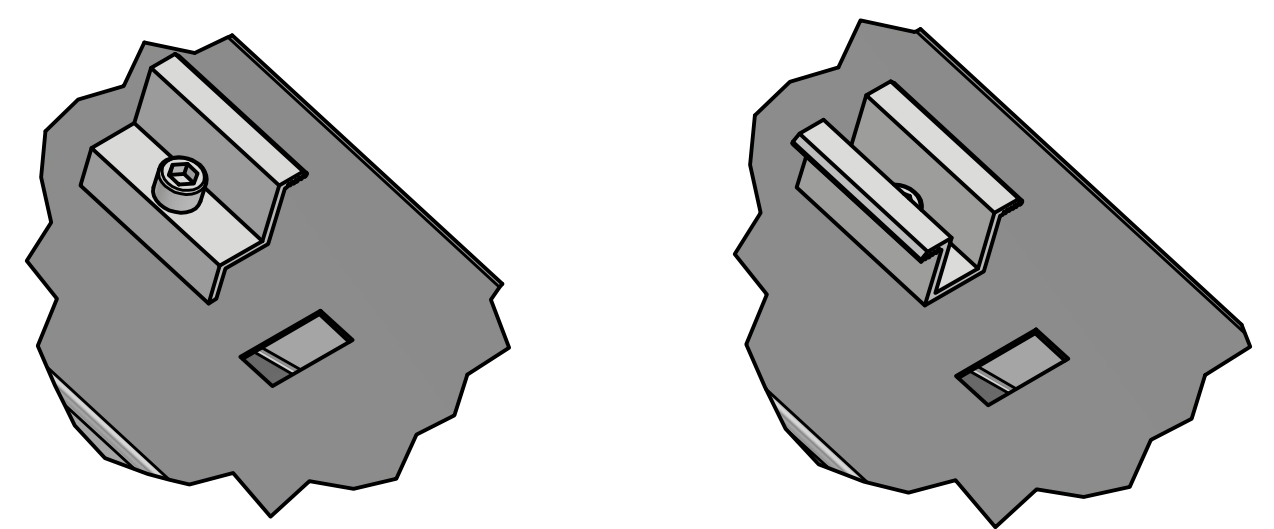

In the next step, we attach the clamps to the triangles, for this purpose we use allenscrews and tighten them with flange nuts. It should be remembered that they are not tightly tightened due to the need to adjust to the modules. As an alternative, basket nuts can be used. They replace the aluminum keyway.

The free grooves will be occupied by the center ticks that distance the two adjacent modules from each other.

Stage 5

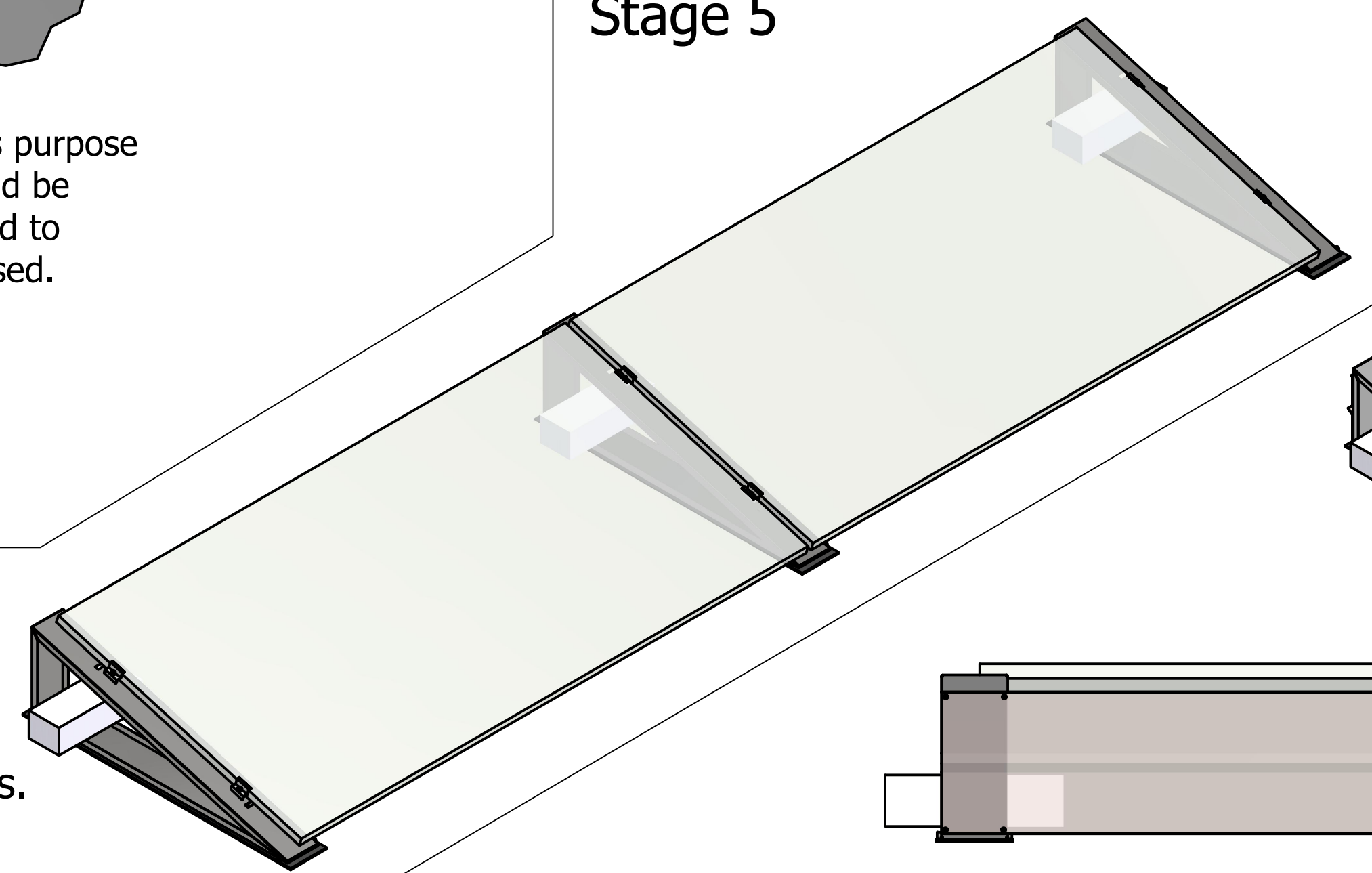

In the last step, we deploy the modules on the structure, then after positioning them properly we tighten the middle and end clamps.

Stage 6 (optional)

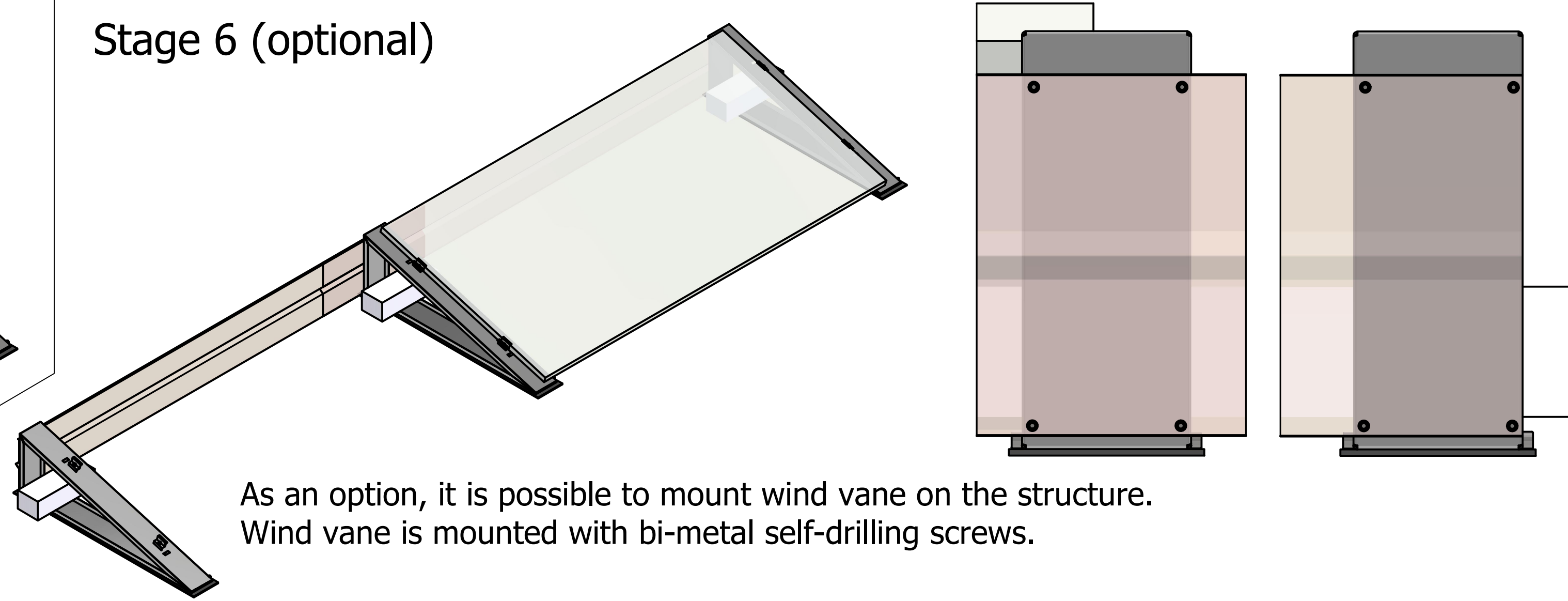

As an option, it is possible to mount wind vane on the structure. Wind vane is mounted with bi-metal self-drilling screws.

