

# Tiger Neo N-type 72HL4-BDV 550-570 Watt BIFACIAL MODULE WITH DUAL GLASS

## N-Type

Positive power tolerance of 0~+3%

IEC61215(2016), IEC61730(2016)

ISO9001:2015: Quality Management System

ISO14001:2015: Environment Management System

ISO45001:2018  
Occupational health and safety management systems

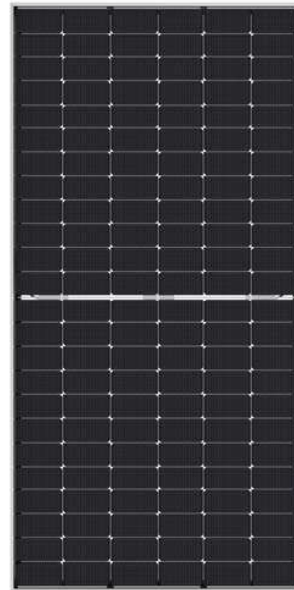

## Key Features



### SMBB Technology

Better light trapping and current collection to improve module power output and reliability.



### PID Resistance

Excellent Anti-PID performance guarantee via optimized mass-production process and materials control.



### Higher Power Output

Module power increases 5-25% generally, bringing significantly lower LCOE and higher IRR.



### Hot 2.0 Technology

The N-type module with Hot 2.0 technology has better reliability and lower LID/LETID.



### Enhanced Mechanical Load

Certified to withstand: wind load (2400 Pascal) and snow load (5400 Pascal).



## LINEAR PERFORMANCE WARRANTY

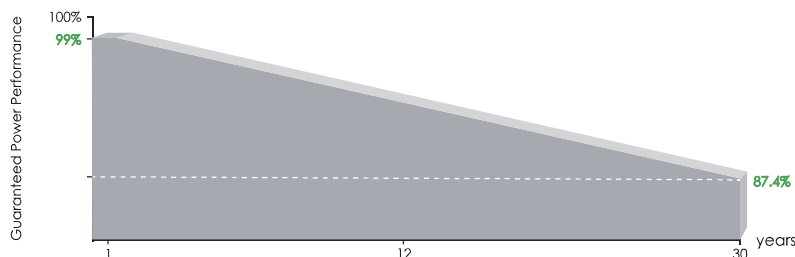

**12** Year Product Warranty

**30** Year Linear Power Warranty

**0.40%** Annual Degradation Over 30 years

## Engineering Drawings

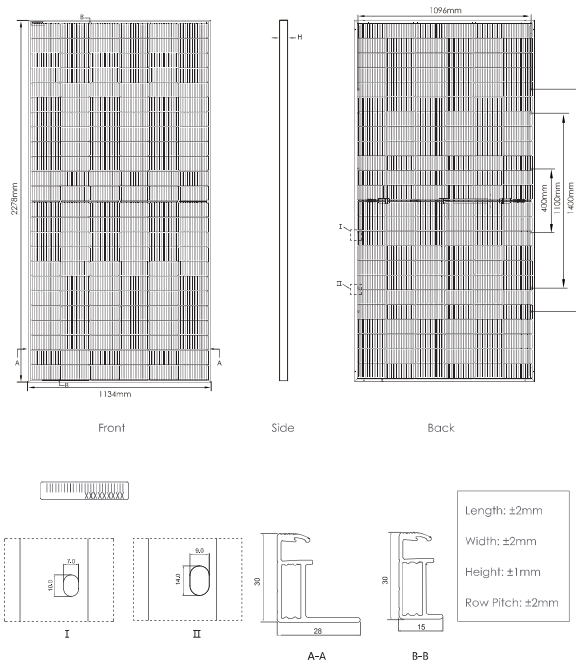

## Packaging Configuration

( Two pallets = One stack )

36pcs/pallets, 72pcs/stack, 720pcs/ 40'HQ Container

## Electrical Performance & Temperature Dependence

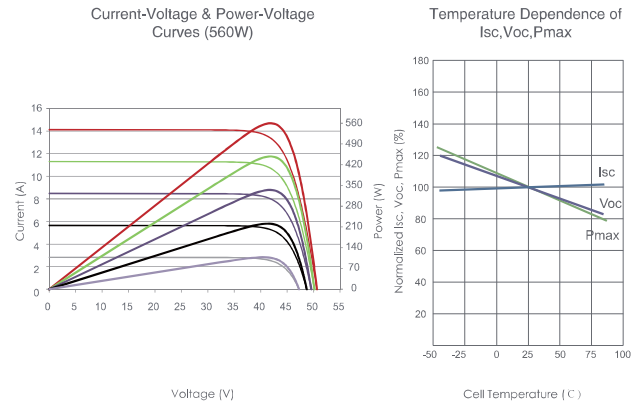

## Mechanical Characteristics

Cell Type	N type Mono-crystalline
No. of cells	144 (2×72)
Dimensions	2278×1134×30mm (89.69×44.65×1.18 inch)
Weight	32 kg (70.55 lbs)
Front Glass	2.0mm, Anti-Reflection Coating
Back Glass	2.0mm, Heat Strengthened Glass
Frame	Anodized Aluminium Alloy
Junction Box	IP68 Rated
Output Cables	TUV 1×4.0mm <sup>2</sup> (+): 400mm, (-): 200mm or Customized Length

## SPECIFICATIONS

Module Type	JKM550N-72HL4-BDV		JKM555N-72HL4-BDV		JKM560N-72HL4-BDV		JKM565N-72HL4-BDV		JKM570N-72HL4-BDV	
	STC	NOCT	STC	NOCT	STC	NOCT	STC	NOCT	STC	NOCT
Maximum Power (Pmax)	550Wp	414Wp	555Wp	417Wp	560Wp	421Wp	565Wp	425Wp	570Wp	429Wp
Maximum Power Voltage (Vmp)	41.58V	39.13V	41.77V	39.26V	41.95V	39.39V	42.14V	39.52V	42.29V	39.65V
Maximum Power Current (Imp)	13.23A	10.57A	13.29A	10.63A	13.35A	10.69A	13.41A	10.75A	13.48A	10.81A
Open-circuit Voltage (Voc)	50.27V	47.75V	50.47V	47.94V	50.67V	48.13V	50.87V	48.32V	51.07V	48.51V
Short-circuit Current (Isc)	14.01A	11.31A	14.07A	11.36A	14.13A	11.41A	14.19A	11.46A	14.25A	11.50A
Module Efficiency STC (%)	21.29%		21.48%		21.68%		21.87%		22.07%	
Operating Temperature(°C)	-40°C~+85°C									
Maximum system voltage	1500VDC (IEC)									
Maximum series fuse rating	30A									
Power tolerance	0~+3%									
Temperature coefficients of Pmax	-0.30%/°C									
Temperature coefficients of Voc	-0.25%/°C									
Temperature coefficients of Isc	0.046%/°C									
Nominal operating cell temperature (NOCT)	45±2°C									
Refer. Bifacial Factor	80±5%									

## BIFACIAL OUTPUT-REAR SIDE POWER GAIN

		JKM550N-72HL4-BDV		JKM555N-72HL4-BDV		JKM560N-72HL4-BDV		JKM565N-72HL4-BDV		JKM570N-72HL4-BDV	
		5%	15%	5%	15%	5%	15%	5%	15%	5%	15%
5%	Maximum Power (Pmax)	578Wp	583Wp	588Wp	593Wp	599Wp					
	Module Efficiency STC (%)	22.36%	22.56%	22.77%	22.97%	23.17%					
15%	Maximum Power (Pmax)	633Wp	638Wp	644Wp	650Wp	656Wp					
	Module Efficiency STC (%)	24.48%	24.71%	24.93%	25.15%	25.37%					
25%	Maximum Power (Pmax)	688Wp	694Wp	700Wp	706Wp	713Wp					
	Module Efficiency STC (%)	26.61%	26.86%	27.10%	27.34%	27.58%					

\*STC: Irradiance 1000W/m<sup>2</sup>

Cell Temperature 25°C

AM=1.5

NOCT: Irradiance 800W/m<sup>2</sup>

Ambient Temperature 20°C

AM=1.5

Wind Speed 1m/s